

VORT QUADRO RANGE

- For the ventilation of medium-sized or large rooms in commercial premises plus bathrooms/showers/toilets/ utilities and kitchens in domestic situations.
- 20 models with or without timer and incorporated humidistat. Wall mounting and built-in versions available.
- Backdraught shutter already installed on the product to avoid air back-flow when the unit is turned off.
- Timer models adjustable between 3 and 20 min.
- HCS models with incorporated humidistat (optional) which turns on the unit when the R.H. exceeds 65% and turns it off when the R.H. drops back to this value.
- Motor with thermal cut-out incorporated.
- The units have a high extraction to overcome pressure loss when long ducts are used. Reduced sound levels with superior certified performances on ducted applications.
- Easy to install and maintain
- Certified performances by IMQ and IMQ Performance.
- Complies with the CEI EN 60335-2-80 standard. IPX4 (safety features third party certified).
- Vort Quadro fans guarantee a low environmental impact. Recyclable materials have been used and the "Design for Disassembly" technique has been followed (2002/96/EC - WEEE)

Design: F. Trabucco & Associates



Dimensions (mm)

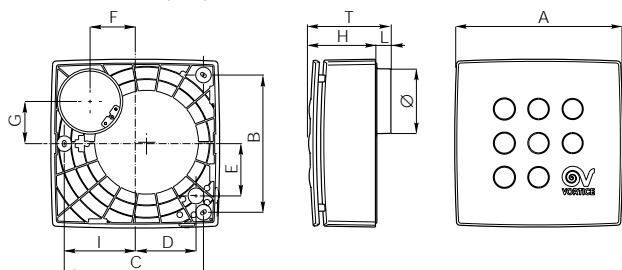

Wall	A	B	C	I	E	D	G	F	L	H	T	Ø
Micro 80	239	195	197	100	74	85	60	64	20	97	117	73.5
Micro 100	239	195	197	100	74	85	60	64	20	97	117	92.5/97
Medio	261	212	215	110	82	95	69	75	20	119	138	92.5/97
Super	290	236	239	125	92	108	81	87	20	144	164	92.5/97

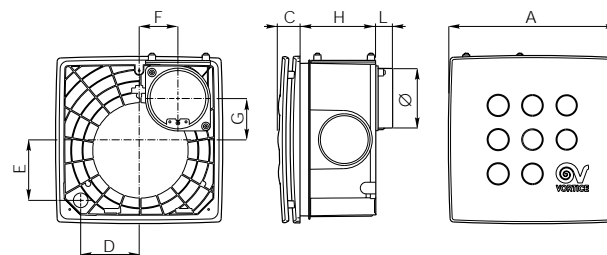

Built-in	A	C	D	E	F	G	H	L	Ø
Micro	258	34	92	90	64	60	118	26	73.5
Medio	287	37	97	103	72	69	130	26	92.5
Super	314	38	120	120	80	81	153	26	92.5

Product	Code		V ~ 50 Hz	W	A	Rpm	Delivery		P max		Lp dB(A) 3 m frontal extraction	Lp dB(A) 3 m side extraction	Approvals	kg	Insulation	°C max	
	TIMER						m³/h	l/s	mm H₂O	Pa							
Micro 80	11638	11648	220-240	19 27	0.10 0.13	1150 1580	60 85	17 24	22 27	216 265	28.7 37	- -		1.79 1.81		cl.II	50
Micro 100	11936	11940	220-240	20 28	0.10 0.13	1180 1600	65 90	18 25	16 22	157 216	32.3 39.2	- -		1.80 1.82		cl.II	50
Micro 100 T HCS	-	11942	220-240	20 28	0.10 0.13	1180 1600	65 90	18 25	16 22	157 216	32.3 39.2	- -		1.82		cl.II	50
Medio	11944	11946	220-240	42 53	0.20 0.26	1380 1800	125 170	35 47	34 37	334 363	36.7 43.4	- -		2.54 2.56		cl.II	40
Medio T HCS	-	11950	220-240	42 53	0.20 0.26	1380 1800	125 170	35 47	34 37	334 363	36.7 43.4	- -		2.56		cl.II	40
Super	11952	11954	220-240	65 95	0.30 0.48	1400 2040	185 270	51 75	42 50	412 491	41.9 48.6	- -		3.77 3.79		cl.II	50
Super T HCS	-	11956	220-240	65 95	0.30 0.48	1400 2040	185 270	51 75	42 50	412 491	41.9 48.6	- -		3.79		cl.II	50
Micro 100 Incasso	12017	12018	220-240	25 33	0.12 0.15	1010 1450	75 110	21 31	20 25	196 245	26.3 34.3	25.9 33.5		1.91 1.93		cl.II	50
Micro 100 I T HCS	-	12019	220-240	25 33	0.12 0.15	1010 1450	75 110	21 31	20 25	196 245	26.3 34.3	25.9 33.5		1.93		cl.II	50
Medio Incasso	12020	12021	220-240	45 60	0.21 0.27	1200 1600	130 180	36 50	34 37	334 363	35.9 41.2	33.4 39.6		2.77 2.79		cl.II	50
Medio I T HCS	-	12022	220-240	45 60	0.21 0.27	1200 1600	130 180	36 50	34 37	334 363	35.9 41.2	33.4 39.6		2.79		cl.II	50
Super Incasso	12023	12024	220-240	70 100	0.31 0.48	1300 1900	190 280	53 78	42 50	412 491	33.6 46.7	30 44.6		4.27 4.29		cl.II	50
Super I T HCS	-	12025	220-240	70 100	0.31 0.48	1300 1900	190 280	53 78	42 50	412 491	33.6 46.7	30 44.6		4.29		cl.II	50

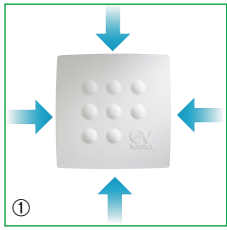

① The air is extracted laterally through an opening concealed beneath the outer cover and drawn from all around the product. Possible dust deposits are invisible from the outside whereas the outer cover remains perfectly clean.

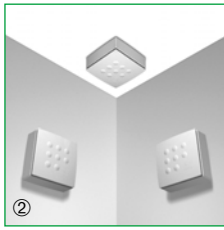

② Wall/ceiling installation. The decentralized hole of the air outlet enables installation in any corner (right or left). Quadro can be ducted to any spigot position by simply rotating the rear box of the unit. The grille will always remain in the upright position.



③ Backdraught shutter. Integrally installed on the appliance, it prevents return air when the appliance is switched off.

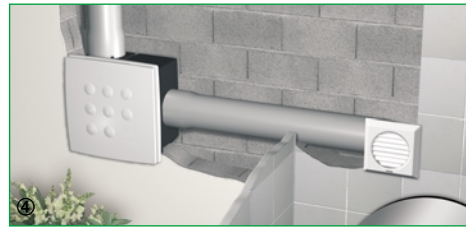

④ For the flush-mounting version the extraction can be installed for either vertical or horizontal outlet pipes. In addition the appliance can be connected with extra piping to change the air of two different rooms.

Pressure/performance curves

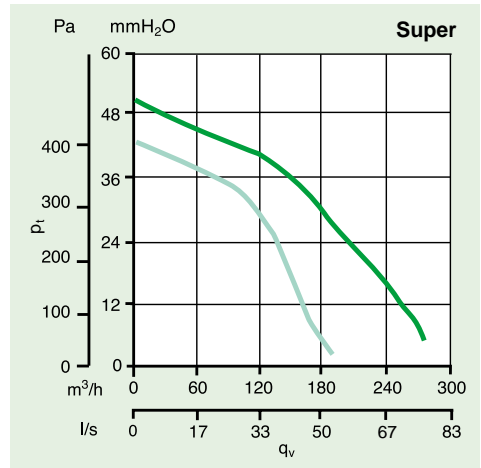
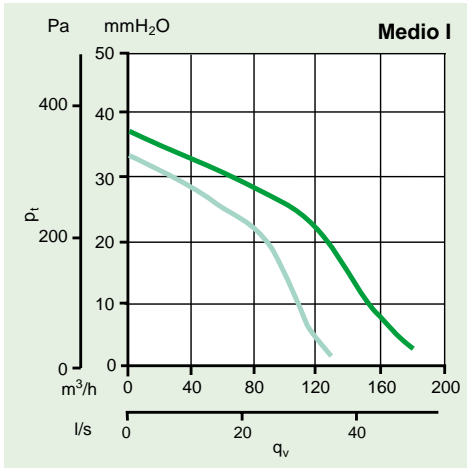
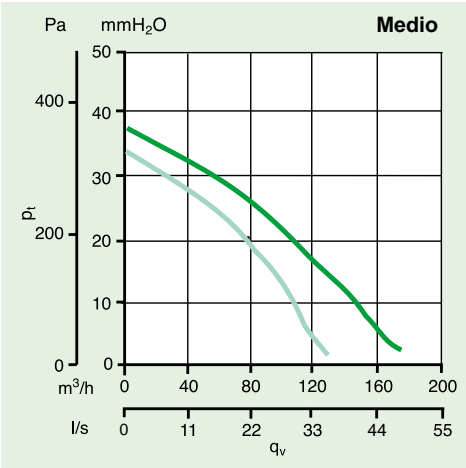
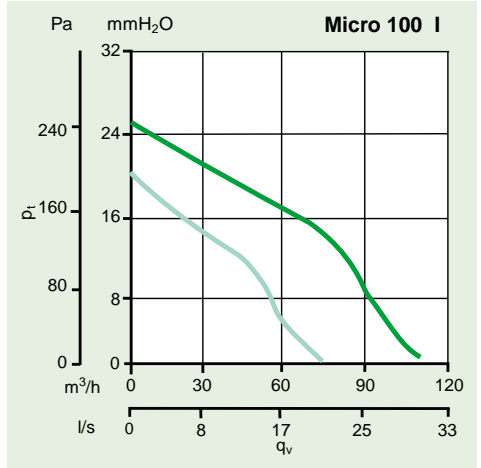
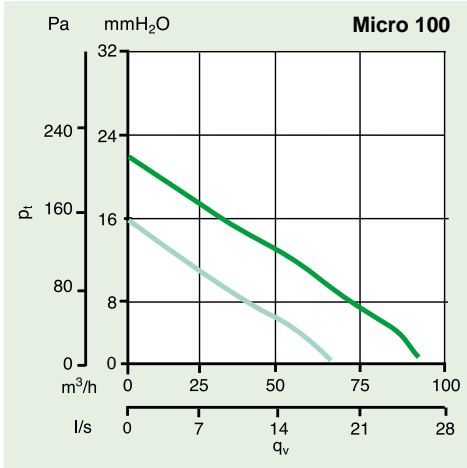
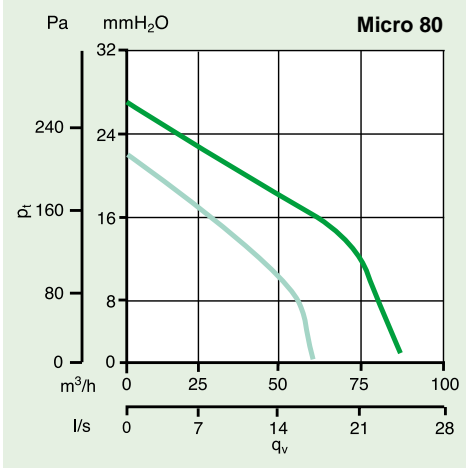

Accessories (see also on page 91)

Model	Code	Product
SCNR electronic speed controller C 1.5 electronic speed controller	12912* 12966	for standard models
SCB Kit	22481	for SCNR (12912)
SCNRB electronic speed controller	12971	for standard models
Air deflector	22310	for all products
Fixed grille	22010	for all products

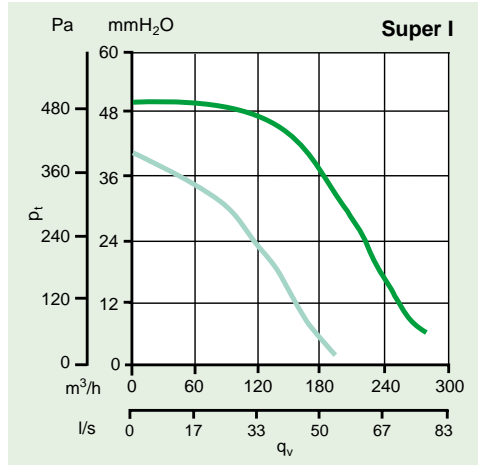

* Upon stock depletion

Wiring diagrams shown on page XXVIII.